

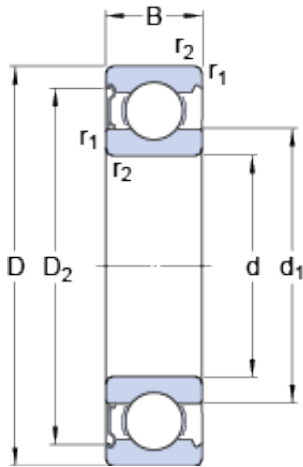

# USK BEARING COMPANY



45 mm x 85 mm x 19 mm skf 6209-Z Deep groove ball bearings

Bearing No. 6209-Z

6209-Z Bearing 2D drawings and 3D CAD models

|   |                          |
|---|--------------------------|
| Size                                      | 85x45x19 mm              |
| Bore Diameter                             | 85 mm                    |
| Outer Diameter                            | 45 mm                    |
| Width                                     | 19 mm                    |
| d   | 45 mm                    |
| D   | 85 mm                    |
| B   | 19 mm                    |
| d <sub>1</sub>                            | 57.6 mm                  |
| D <sub>2</sub>                            | 75.19 mm                 |
| r <sub>1,2</sub> - min.                   | 1.1 mm                   |
| d <sub>a</sub> - min.                     | 52 mm                    |
| d <sub>a</sub> - max.                     | 57.5 mm                  |
| D <sub>a</sub> - max.                     | 78 mm                    |
| r <sub>a</sub> - max.                     | 1 mm                     |
| Basic dynamic load rating - C             | 35.1 kN                  |
| Basic static load rating - C <sub>0</sub> | 21.6 kN                  |
| Fatigue load limit - P <sub>u</sub>       | 0.915 kN                 |
| Reference speed                           | 17000 r/min              |
| Limiting speed                            | 11000 r/min              |
| Calculation factor - k <sub>r</sub>       | 0.025                    |
| Calculation factor - f <sub>0</sub>       | 14.2                     |
| Category                                  | Single Row Ball Bearings |
| Inventory                                 | 0.0                      |
| Manufacturer Name                         | SKF                      |



# USK BEARING COMPANY

|                                 |  |
|---------------------------------|--|
| Minimum Buy Quantity            | N/A  |
| Weight / Kilogram               | 0.425  |
| EAN                             | 7316577737854  |
| Product Group                   | B00308   |
| Enclosure                       | 1 Metal Shield   |
| Precision Class                 | ABEC 1   ISO P0  |
| Maximum Capacity / Filling Slot | No   |
| Rolling Element                 | Ball Bearing   |
| Snap Ring                       | No   |
| Internal Special Features       | No   |
| Cage Material                   | Steel  |
| Internal Clearance              | C0-Medium  |
| Inch - Metric                   | Metric   |
| Long Description                | 45MM Bore; 85MM Outside Diameter; 19MM Outer Race Diameter; 1 Metal Shield; Ball Bearing; ABEC 1   ISO P0; No Filling Slot; No Snap Ring; No Internal Special Features |
| Category                        | Single Row Ball Bearing  |
| UNSPSC                          | 31171504   |
| Harmonized Tariff Code          | 8482.10.50.68  |
| Noun                            | Bearing  |
| Keyword String                  | Ball   |
| Manufacturer URL                | <a href="http://www.skf.com">http://www.skf.com</a>  |
| Manufacturer Item Number        | 6209-Z   |
| Weight / LBS                    | 0.94   |
| Outer Race Width                | 0.748 Inch   19 Millimeter   |
| Bore                            | 1.772 Inch   45 Millimeter   |
| Outside Diameter                | 3.346 Inch   85 Millimeter   |
| d <sub>1</sub>                  | 57.6 mm  |
| D <sub>2</sub>                  | 75.19 mm   |
|                                 |  |



## USK BEARING COMPANY

|                                |          |
|--------------------------------|----------|
| $r_{1,2}$ min.                 | 1.1 mm   |
| $d_a$ min.                     | 52 mm    |
| $d_a$ max.                     | 57.5 mm  |
| $D_a$ max.                     | 78 mm    |
| $r_a$ max.                     | 1 mm     |
| Basic dynamic load rating C    | 35.1 kN  |
| Basic static load rating $C_0$ | 21.6 kN  |
| Fatigue load limit $P_u$       | 0.915 kN |
| Calculation factor $k_r$       | 0.025    |
| Calculation factor $f_0$       | 14.2     |
| Mass bearing                   | 0.42 kg  |