

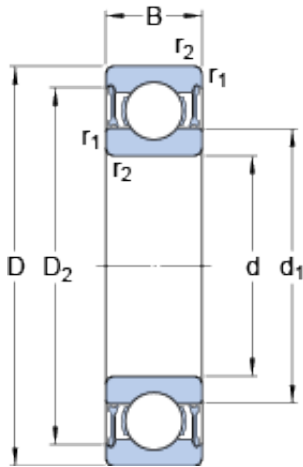

USK BEARING COMPANY



65 mm x 85 mm x 10 mm skf 61813-2RZ Deep groove ball bearings

Bearing No. 61813-2RZ

61813-2RZ Bearing 2D drawings and 3D CAD models

Size	85x65x10 mm
Bore Diameter	85 mm
Outer Diameter	65 mm
Width	10 mm
d	65 mm
D	85 mm
B	10 mm
d ₁	71.6 mm
D ₂	80.5 mm
r _{1,2} - min.	0.6 mm
d _a - min.	68.2 mm
d _a - max.	71.5 mm
D _a - max.	81.8 mm
r _a - max.	0.6 mm
Basic dynamic load rating - C	12.4 kN
Basic static load rating - C ₀	12.7 kN
Fatigue load limit - P _u	0.54 kN
Reference speed	16000 r/min
Limiting speed	8000 r/min
Calculation factor - k _r	0.015
Calculation factor - f ₀	17
Category	Single Row Ball Bearings
Inventory	0.0
Manufacturer Name	SKF



USK BEARING COMPANY

Minimum Buy Quantity	N/A
Weight / Kilogram	0.146
EAN	7316577121691
Product Group	B00308
Enclosure	2 Seals
Precision Class	ABEC 1 ISO P0
Maximum Capacity / Filling Slot	No
Rolling Element	Ball Bearing
Snap Ring	No
Internal Special Features	No
Cage Material	Steel
Enclosure Type	Non-Contact Seal
Internal Clearance	C0-Medium
Inch - Metric	Metric
Long Description	65MM Bore; 85MM Outside Diameter; 10MM Outer Race Diameter; 2 Seals; Ball Bearing; ABEC 1 ISO P0; No Filling Slot; No Snap Ring; No Internal Special Features
Category	Single Row Ball Bearing
UNSPSC	31171504
Harmonized Tariff Code	8482.10.50.68
Noun	Bearing
Keyword String	Ball
Manufacturer URL	http://www.skf.com
Manufacturer Item Number	61813 2RZ
Weight / LBS	0.31
Outer Race Width	0.394 Inch 10 Millimeter
Bore	2.559 Inch 65 Millimeter
Outside Diameter	3.346 Inch 85 Millimeter
bore diameter:	65 mm



USK BEARING COMPANY

static load capacity:	12.7 kN
outside diameter:	85 mm
precision rating:	Not Rated
overall width:	10 mm
finish/coating:	Uncoated
bore type:	Round
cage material:	Steel
closure type:	Double Sealed
outer ring width:	10 mm
row type & fill slot:	Single Row Non-Fill Slot
fillet radius:	0.6 mm
internal clearance:	C0
maximum rpm:	8000 RPM
operating temperature range:	-40 to +210 ° F
series:	61
dynamic load capacity:	12.4 kN
d_1	71.4 mm
D_2	80.5 mm
$r_{1,2}$ min.	0.6 mm
d_a min.	68.2 mm
d_a max.	71.5 mm
D_a max.	81.8 mm
r_a max.	0.6 mm
Basic dynamic load rating C	12.4 kN
Basic static load rating C_0	12.7 kN
Fatigue load limit P_u	0.54 kN
Calculation factor k_r	0.015
Calculation factor f_0	17
Mass bearing	0.13 kg