

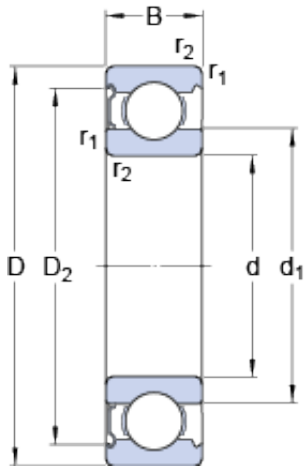

USK BEARING COMPANY



105 mm x 225 mm x 49 mm skf 6321-Z Deep groove ball bearings

Bearing No. 6321-Z

6321-Z Bearing 2D drawings and 3D CAD models

Size	225x105x49 mm
Bore Diameter	225 mm
Outer Diameter	105 mm
Width	49 mm
d	105 mm
D	225 mm
B	49 mm
d ₁	141.5 mm
D ₂	193.35 mm
r _{1,2} - min.	3 mm
d _a - min.	119 mm
d _a - max.	140.9 mm
D _a - max.	211 mm
r _a - max.	2.5 mm
Basic dynamic load rating - C	182 kN
Basic static load rating - C ₀	153 kN
Fatigue load limit - P _u	5.1 kN
Reference speed	6300 r/min
Limiting speed	4000 r/min
Calculation factor - k _r	0.03
Calculation factor - f ₀	13
d ₁	141.5 mm
D ₂	193.35 mm
r _{1,2} min.	3 mm



USK BEARING COMPANY

d_a min.	119 mm
d_a max.	140.9 mm
D_a max.	211 mm
r_a max.	2.5 mm
Basic dynamic load rating C	182 kN
Basic static load rating C_0	153 kN
Fatigue load limit P_u	5.1 kN
Calculation factor k_r	0.03
Calculation factor f_0	13.2
Mass bearing	8.17 kg